

Waste King

COMMERCIAL

by Anaheim Manufacturing

PHONE: (800) 854-3229 • FAX: (800) 454-4406
www.wasteking.com

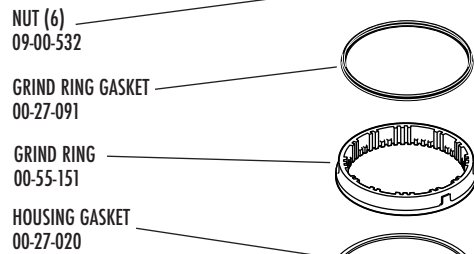
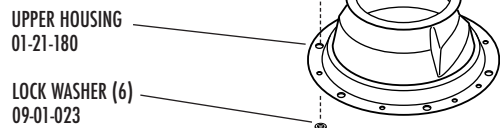
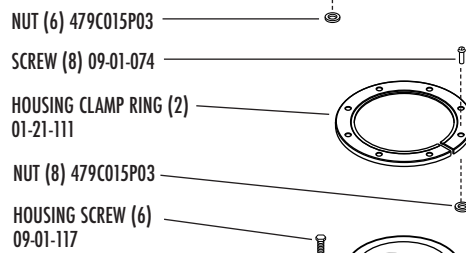
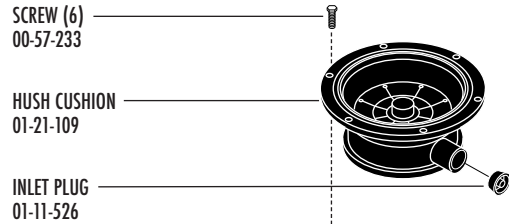

RIPPER KIT 01-22-660

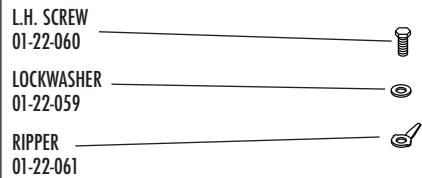

TURNTABLE ASSEMBLY 01-22-291

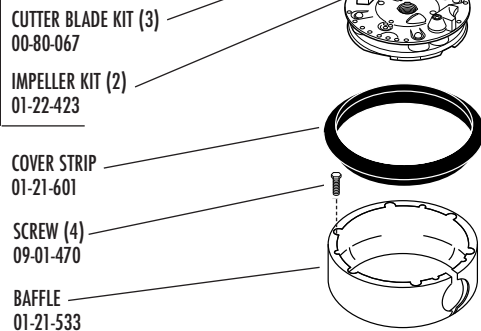

SINCE 11-2002
SEAL KIT 645P19S02

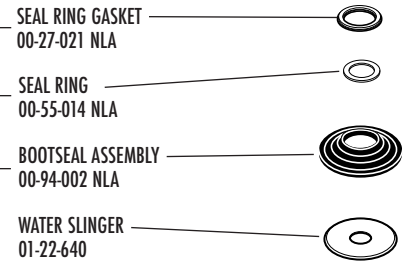

SEAL KIT 00-94-073

SPACER 01-21-588

MOTOR ASSEMBLY 463P010S13

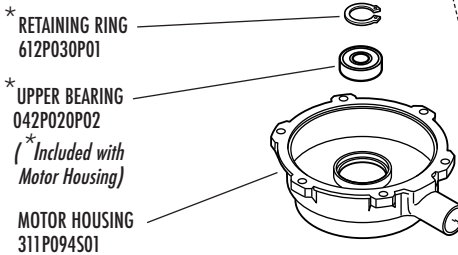

JUNCTION BOX ASSEMBLY 069P002S01 069P003S01** (Protector Assy. not included)



ROTATING SWITCH
695P036P01

RETAINING RING
612P029P01

LOWER BEARING
042P020P01

SPRING
675P026P01

STATIONARY SWITCH
695P034P01
(re-use screw)

END SHIELD
311P097P01

FAN
239P001P01

FAN RETAINING RING
612P028P01

FAN COVER
183P002P01

SCREW (3)
636P038P01

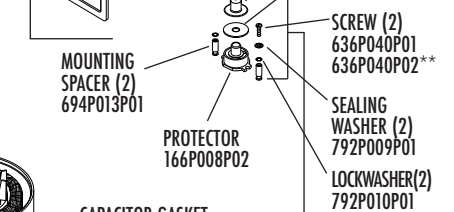
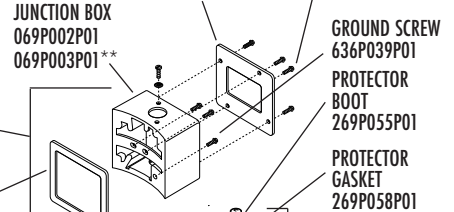
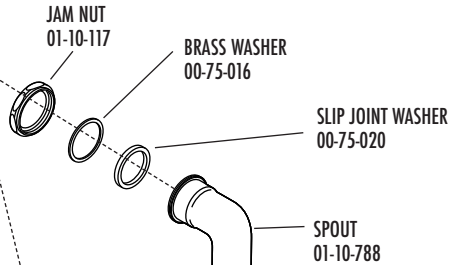

PROTECTOR ASSEMBLY 166P008S02

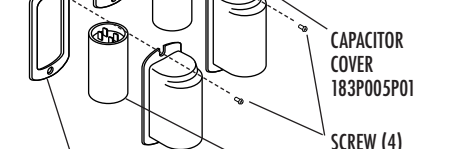

FAN KIT 239P001S01

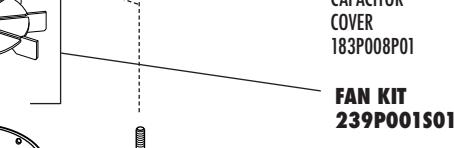

Waste King

COMMERCIAL

by Anaheim Manufacturing

PHONE: (800) 854-3229 • FAX: (800) 454-4406
www.wasteking.com

SCREW (6)
00-57-233

HUSH CUSHION
01-21-109

INLET PLUG
01-11-526

CUSHION CLAMP RING
00-55-090

NUT (6) 479C015P03

SCREW (8) 09-01-074

HOUSING CLAMP RING (2)
01-21-111

NUT (8) 479C015P03

HOUSING SCREW (6)
09-01-117

UPPER HOUSING
01-21-180

LOCK WASHER (6)
09-01-023

NUT (6)
09-00-532

GRIND RING GASKET
00-27-091

GRIND RING
00-55-151

HOUSING GASKET
00-27-020

**RIPPER KIT
01-22-660**

L.H. SCREW
01-22-060

LOCKWASHER
01-22-059

RIPPER
01-22-061

**TURNTABLE ASSEMBLY
01-22-291**

CUTTER BLADE KIT (3)
00-80-067

IMPELLER KIT (2)
01-22-423

COVER STRIP
01-21-601

SCREW (4)
09-01-470

BAFFLE
01-21-533

SINCE 11-2002
SEAL KIT 645P19S02

SEAL RING GASKET
00-27-021 NLA

SEAL RING
00-55-014 NLA

BOOTSEAL ASSEMBLY
00-94-002 NLA

WATER SLINGER
01-22-640

SPACER 01-21-588

**MOTOR ASSEMBLY
463P010S33**

* RETAINING RING
612P030P01

* UPPER BEARING
042P020P02

(* Included with
Motor Housing)

MOTOR HOUSING
311P094S01

**JUNCTION BOX ASSEMBLY
069P002S01
069P003S01****
(Protector Assy. not included)

JUNCTION BOX GASKET
269P057P01
269P066P01**

LOWER BEARING
042P020P01

SPRING
675P026P01

END SHIELD
311P097P01

FAN
239P001P01

FAN RETAINING RING
612P028P01

FAN COVER
183P002P01

SCREW (3)
636P038P01

PARTS LIST

MODEL 1250-3 BEGINNING WITH #96-06-15118-1

**SEAL KIT
00-94-073**

JAM NUT
01-10-117

BRASS WASHER
00-75-016

SLIP JOINT WASHER
00-75-020

SPOUT
01-10-788

COVER
183P003P01
174P075P01**
269P065P01**

JUNCTION BOX
SCREWS (6)
636P038P02

GROUND SCREW
636P039P01

PROTECTOR
BOOT
269P055P01

PROTECTOR
GASKET
269P058P01

SCREW (2)
636P040P01
636P040P02**

SEALING
WASHER (2)
792P009P01

LOCKWASHER(2)
792P010P01

**PROTECTOR
ASSEMBLY
166P008S32**

JUNCTION BOX
069P002P01
069P003P01**

MOUNTING
SPACER (2)
694P013P01

PROTECTOR
166P008P32

**PROTECTOR
ASSEMBLY
166P008S32**

**FAN KIT
239P001S01**

THRU-BOLT (4)
687P004P02